

works
radu cioca

raducioca@yahoo.com
www.raducioca.blogspot.com
www.slashgallery.ro

+ 4 0 7 4 3 5 3 0 4 9 6



The exhibition interprets the architectural concept of the "Superbia" project into an installation of contrasts and subjective perspectives. The earth is the emotional, dynamic and real factor which charges and torments the gallery, in contrast with a series of objects with different individualities and static materialization. They are different channels through which it speaks about materialization of power, pride, and obsession of material possession in contrast with a humble and natural material like earth. An ensemble about individualism, value, effort, aspirations and status, about contrast between reality and its projection, and the difference of spatial processing between interior and exterior.

superbia

2010

exhibition at the Romanian National Pavilion in The New Gallery of the Romanian Institute for Culture and Humanistic Research in Venice / La Biennale di Venezia / 12th International Architecture Exhibition













Superbia







It'all about you.
 You are now designed to live by preconception.
 You already chose before you open the 'book'.
 You rapidly assume that it's a regular book, not an art object.
 You already know what answers you want to receive from it.



I give you anything you want

2010

paper print/

12/17/1cm





flags
[in hoc signo vinces] 2010

graphite on paper 2x(50x70)
cotton flags 2x(250x15cm)
still projection / air blowers/



The borrowed symbols create two equal structures (in terms of composition and realization) of two very different principles, which are then projected on two dynamic white flags. The installation makes reference to a type of propaganda in which powerful and radical ideas are leveled into a new blurred message, with chaotic content, where all semiotic elements are treated equal, regardless of their true significance. The notion of good and evil becomes a grey zone.



The next three sculptures:

trophy/
inner song/
black/

are part of the same study on symbols,
communication and alienation of truth.

trophy

2010

porcelain/ wood panel/

85x85x10cm





inner song

ceramics/ inox/ light box/ wood/

2010

63/30/115cm



black

2010

painted cement/ glass/
inox/ wood/

27x15x80cm

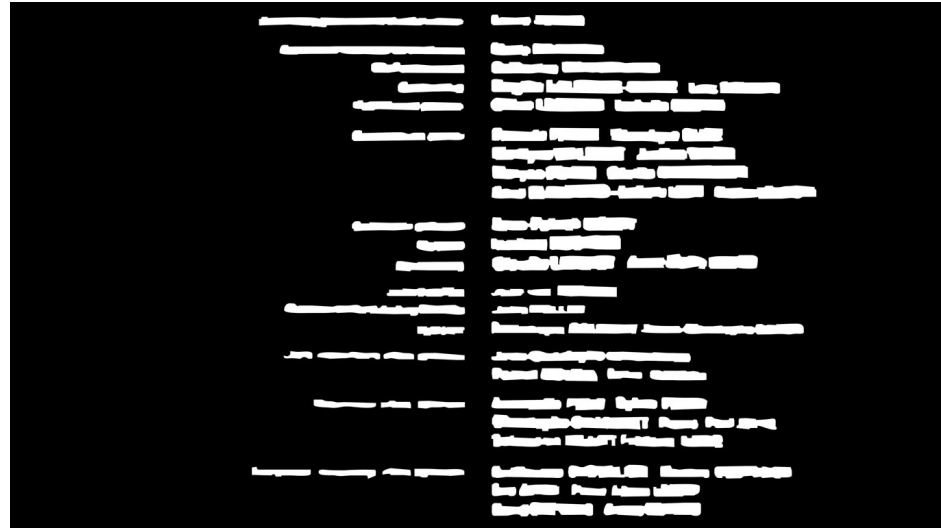

The animation is a loop of abstract white shapes on a black background that due to proportions, alignment and direction of movement, creates the impression of the specific line-up of credits at the end of a movie. It's an experience based on tension and the state of isolated meditation while amongst others, that you can encounter at the end of a movie projection, right before the lights turn on. A moment between reality and fiction, when we almost borrow from the sensitive experience featured in the movie. The lack of the actual movie wants to project this experience on the reality of our times, and our constant fear of change.

the end

2010

video installation, 1' 47" loop / soundtrack/
black granite tile 100cmx100cm/ acrylic paint/



simulated installation view



The premise for this installation resides in the nature of the space where the gallery that invited me is established. It's an old building with very small apartments, situated in center of an active city. The state of isolation while amongst others, is very obvious here, and it's important because it's becoming almost a pathological trend now. The gesture of covering the entire surface of the gallery floor with clay was dictated by this (like a delimitation mark of where someone lived). Being self-aware of your position in space and the relation with others becomes a social necessity.

inhabitanace

2008

site-specific installation

clay/ apartment place/ stickers/
digital renders/ electric light

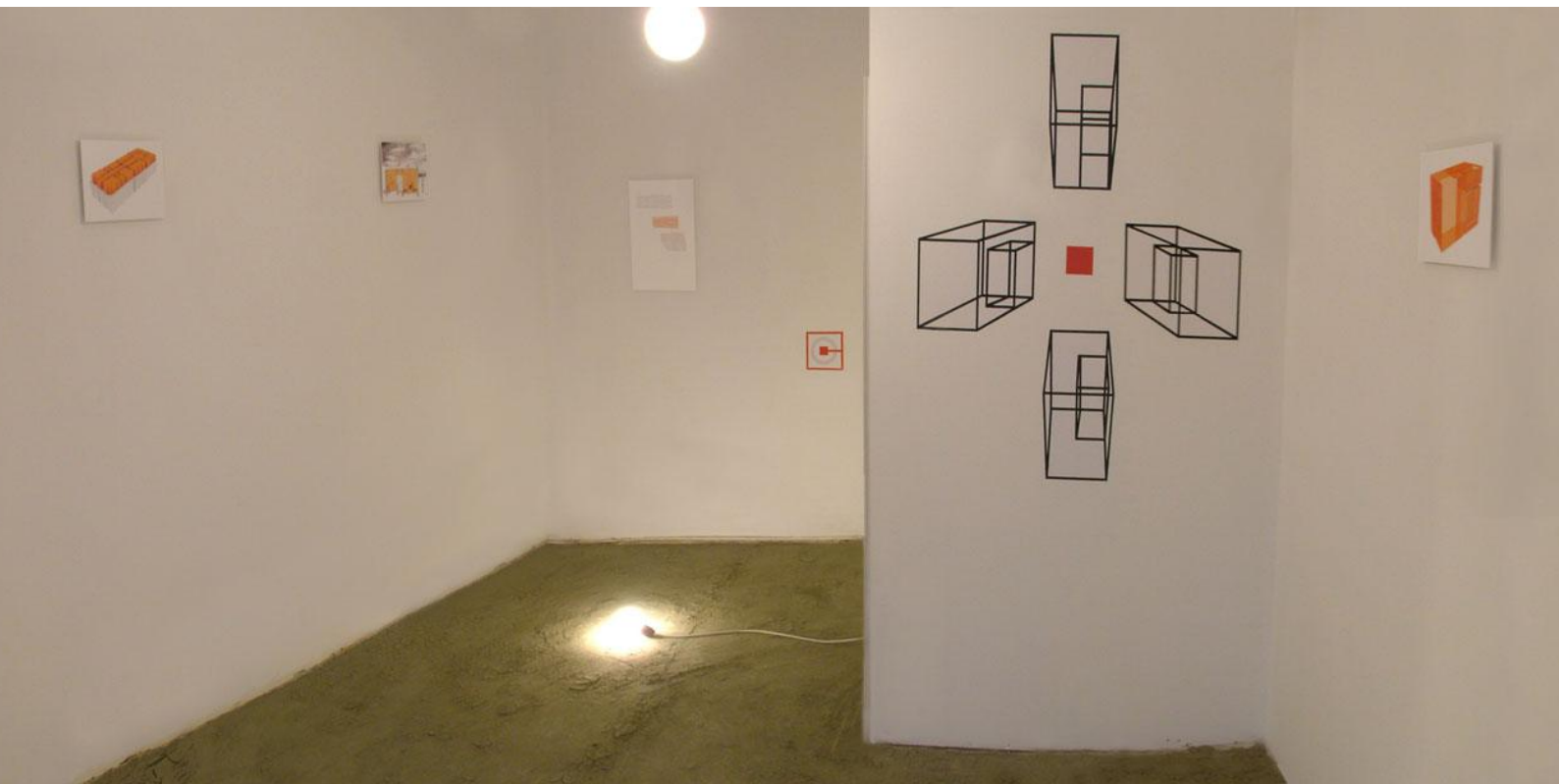

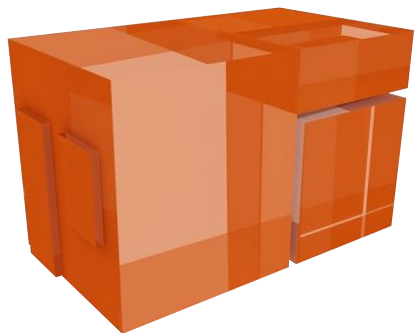
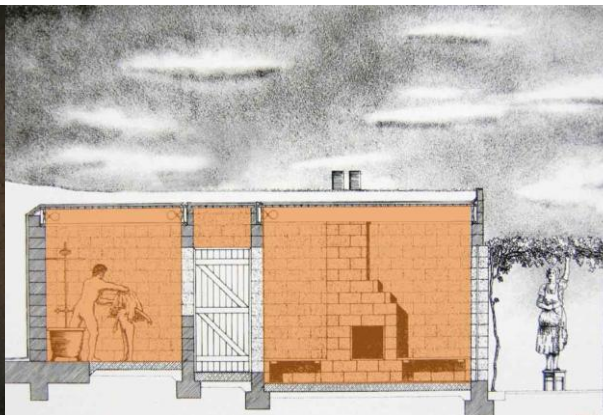

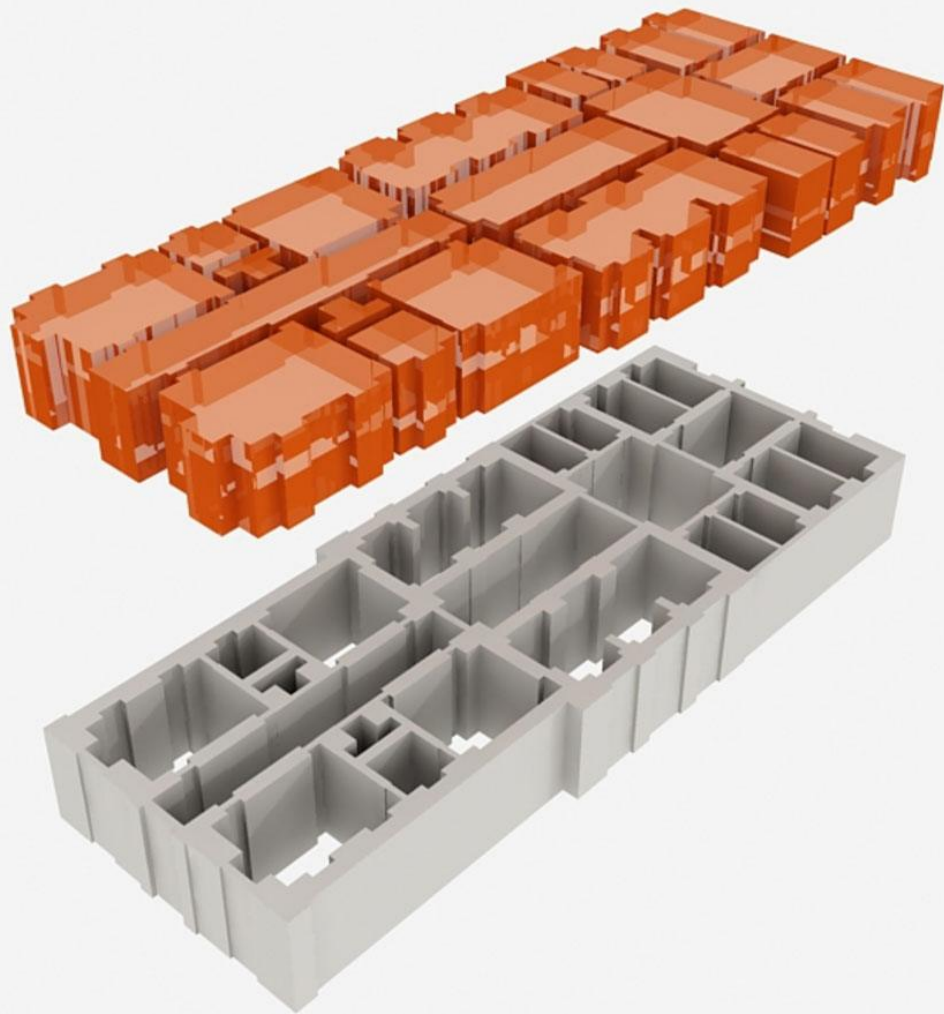

raducioca@yahoo.com
www.raducioca.blogspot.com
www.slashgallery.ro

+ 4 0 7 4 3 5 3 0 4 9 6